



banTamp xL User Manual



banTamp xL 用户使用说明

Safety instructions

Thank you for purchasing our products!

Important safety instructions



CAUTION: TO REDUCE THE RISK OF ELECTRIC SHOCK, DO NOT REMOVE COVER (OR BACK). NO USER-SERVICEABLE PARTS INSIDE. REFER SERVICING TO QUALIFIED SERVICE PERSONNEL.

WARNING: TO REDUCE THE RISK OF FIRE OR ELECTRIC SHOCK, DO NOT EXPOSE THIS APPARATUS TO RAIN OR MOISTURE.

The lightning flash with arrowhead symbol within an equilateral triangle is intended to alert the user to the presence of uninsulated “dangerous voltage” within the product’s enclosure that may be of sufficient magnitude to constitute a risk of electric shock to persons.

The exclamation point within an equilateral triangle is intended to alert the user to the presence of important operating and maintenance (servicing) instructions in the literature accompanying the product.

This symbol is intended to alert the user—Use only with the cart, stand, tripod, bracket, or table specified by the manufacturer, or sold with the apparatus. When a cart is used, use caution when moving the cart/apparatus combination to avoid injury from tip-over.

User instructions: After you turn on the banTamp xL, the tube warms up for the first 20-30 seconds, the unstable sound during this period is normal.

-1-

Detailed safety instructions

- For your safety and let you be familiar with this product, please read all the safety and operation instructions before use.
- Please keep this user manual for future use and maintenance.
- Please follow all the safety instructions on the product or in the user manual.
- Use the attached power adapter only. If use other power adapter, it will damage the internal circuits or increase noise.
- Keep it away from children!
- Please install this product according to manufacturer’s instructions. Put it in places that have good ventilation and heat dissipation. Don’t block any ventilation openings nor cover it with cloth and the like.
- Don’t use it near water or damp areas, don’t drop water or other liquid substance into this product;
- Don’t use it near heat sources, such as heater, electrothermal oven, high power amplifier and more.
- Don’t put hazardous chemicals on the product, inflammable and explosive substances such as alcohol, thinner and so on.
- Do not use alcohol or other cleaning fluids to clean this product, otherwise it will damage the surface, use a clean dry cloth when necessary.
- Don’t damage the power cord or plug. Don’t pull the power cord and other parts. Please unplug it if you need to move this product.
- Please turn off the power switch and unplug the AC power socket during thunderstorm, lightning or if it is not in use for a long time.
- Should any of the following occur, please switch it off and unplug it and contact your local distributor or have it repaired by qualified personnel.
 - Metal or other solid object or liquid falls into the cabinet, or gets caught in the rain.
 - The power cord or power plug were damaged, cable core are exposed or wire break.
 - The product is in smoke, peculiar smell or other abnormal condition.
 - The product falls on the ground or malfunctions.

-2-

Panel instruction

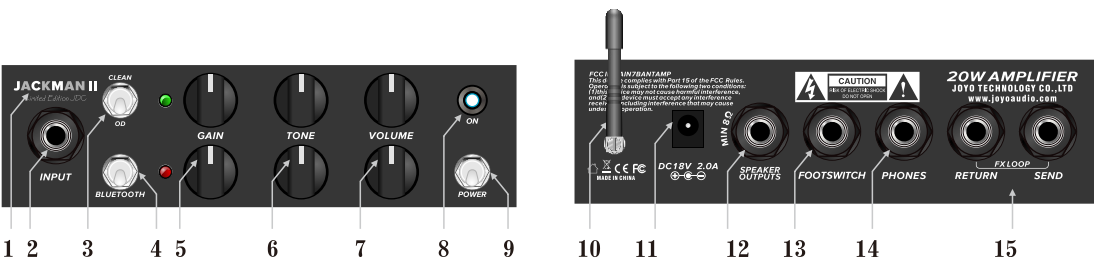

Front panel

- Head’s Model.
- Guitar Input.
- Channel Switch: for choosing the channel.
- Bluetooth Switch: for turning on/off banTamp xL’s Bluetooth function.
- Gain Knob: adjust the Gain.
- Tone Knob: adjust the tone brightness.
- Volume Knob: adjust the volume.
- Power/Bluetooth indicator: turn on banTamp xL, the indicator becomes red, then turn on Bluetooth switch, the indicator changes from red to blue.
- Power Switch: turn on/off banTamp xL.

Rear panel

- Bluetooth Antenna
- Power Interface: connects to DC 18V/2.0A power adapter for power supply, make sure to use the attached power adapter.
- Speaker Output: please connect with speaker impedance that is 8Ω or more than 8Ω!
- Important notes: when connected with speaker impedance that is more than 8Ω, banTamp xL’s power will be reduced.
- Channel-switching Footswitch pedal’s Jack
- Headphone Output: the amp becomes mute when it connects to headphones.
- FX LOOP: connects effect pedal input to banTamp xL’s SEND Jack, and connects effect pedal output to banTamp xL’s RETURN Jack.

-3-

Connection

Bluetooth connection

- Turn on the Bluetooth slide switch.
- Its power indicator changes from red to blue.
- Switch on the Bluetooth of your equipment, wait for it to locate banTamp xL. Please note that the names located a re according to different models you have bought, the names are on the upper side of banTamp xL’s input jack as shown in the picture, for example, “JACKMAN II”.
- Click the related device and match.

Cabinet impedance matching

The matched speaker impedance is 8Ω, of course, 16Ω works too, but banTamp xL achieves maximum power output only when speaker impedance is 8Ω. While with 16Ω, banTamp xL’s power reduces.

Please don’t connect with speaker impedance that is less than 8Ω!

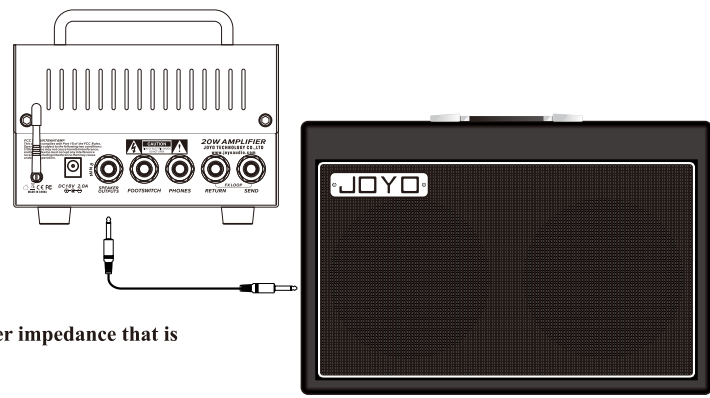

-4-

Specifications:

Power adapter: INPUT AC 100-240V 50/60Hz OUTPUT DC18V/2.0A
Rated power:20W/8Ω
Speaker Impedance:8Ω
Bluetooth version:4.0
Headphone impedance: Standard 32Ω Minimum16Ω
Dimension:163mm×110mm×140mm
Weight:1300g

Package content:

- banTamp xL x1
- Power adapter x1
- Owner’s manual x1
- Power cablex1
- Channel-switching Footswitch Connecting Cable×1
- Channel-switching Footswitch pedal x1
- Speaker cable x1

JOYO TECHNOLOGY CO., LTD

Address: 2/F, Lushi Industry Building, 28th District, Bao’an, Shenzhen, 518101 China.

www.joyo-amps.com Email:info@joyoaudio.com Tel: 0086-755-29765381

JOYO Technology is committed to guarantee the highest quality standards. All Technical pictures are only for your information, subject to the actual products.

-5-

安全提示

感谢您购买我们的产品!

重要的安全说明



注意：机内无用户可用备件! 为了防止触电, 切勿自行拆卸机盖! 必要时需由专业人士维修!

警告：为防止发生火灾或触电危险, 本机切勿受雨淋或受潮!

等边三角形中带有闪电电型箭头, 该符号用来告诫用户——机内有危险电压的绝缘部分, 易造成电击的危险。

等边三角形中带有感叹号, 该符号用来提醒用户——机器附件中有重要的操作和保养说明, 请查阅使用说明书。

该符号警告用户——禁止推移在最顶端装有机器而又无保护措施的可移动机架, 谨防最顶端的机器跌落给您带来不必要的人身伤害。为保护您的利益, 请使用由该制造厂商所生产或推荐的可移动机架、三角架、脚架、固定架、控制台等配件。

用户须知：在刚开机20-30秒前为电子管预热, 期间的声音不稳定属正常情况。

-1-

详细的安全说明

- 为了您的安全和能更快地熟练使用本产品, 使用前请先详细阅读并理解本书中所有的安全与使用说明。
- 为了您以后能更加方便地使用和保养本产品, 请妥善保管好本使用说明书以供必要时查阅。
- 为了您能更加安全地使用本产品, 请遵守在设备上和说明书中所有的警告与注意事项。
- 只能使用本机提供的电源适配器, 若使用其它规格的电源适配器, 可能会损坏本机或产生噪音。
- 请将本产品收藏于儿童不宜获得的地方! 请不要将本产品拿给儿童玩耍!
- 请查阅并按制造商厂商的方法来安装本机器, 请置它在易通风散热地方。请勿阻塞机器上所有的通风散热孔。不要用物品覆盖着本机器;
- 禁止在靠近水或潮湿的地方使用本机器, 禁止将水或其它液体之类的东西滴入或倒入机内;
- 不要在靠近热源的地方使用本机器, 如加热器、暖气机、电热炉、大功率放大器等各种易发热设备。
- 请勿将易发生危险的物品放置在机器上。易燃易爆如酒精、天那水之类的医疗及化学用品等等。
- 请勿用化学溶剂如酒精之类的物品清洁本机器, 否则会对机器表面造成损伤, 必要时请用清洁的干布擦拭。
- 应避免电源线及插头受到损伤或损坏。不要强行拉扯电源线及其它组件, 若要移动本装置请拔下电源插头。
- 当打雷或闪电、或较长时间不使用本机器, 请立即关闭本机的电源并拔出交流电源插头。
- 若发生以下异常情况时, 请立即关闭本机的电源并拔下电源插头, 并与当地经销商联系或由专业人士维修。
 - 金属之类或其它异物落入机器内; 水或其它液体进入机器内; 或被雨淋后。
 - 当电源线或电源插头受到损伤, 如线芯露出或断线。
 - 机器冒烟、有异味或出现其它异常情况时。
 - 机器跌落在地上后或工作不正常等情况时。

-2-

面板说明

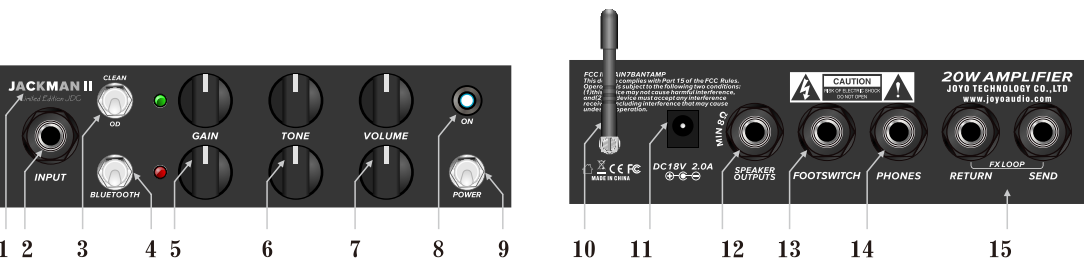

前面板

- 箱头型号
- 吉他输入接口
- 通道切换开关:用来选择箱头的通道。
- 蓝牙开关:打开/关闭banTamp xL的蓝牙功能。
- 增益调节旋钮:调节增益度大小。
- 音色调节旋钮:调节音色明亮度。
- 音量调节旋钮:调节音量大小。
- 电源/蓝牙指示灯:开启banTamp xL设备后,该指示灯点亮为红色灯,在开启设备后,打开蓝牙开关,该指示灯由红色灯转变为蓝色灯。
- 电源开关:开启/关闭banTamp xL设备。

后面板

- 蓝牙天线
- 电源接口:用于接入DC 18V/2.0A格的电源适配器, 为设备供电使用,务必使用随机附带的配置。
- 喇叭输出接口:此接口为箱头喇叭的输出接口, 请务必连接8Ω或更大阻抗的箱体
注意：当接入大于8Ω阻抗箱体时, banTamp xL功率将随之减小。
- 通道切换踏板接口
- 耳机输出接口:用于接入耳机, 在接入耳机时,接入设备的箱体会自动静音。
- 效果回路:将效果器的输入与banTamp xL的SEND接口连接, 效果器的输出与banTamp xL的RETURN接口连接。

-3-

连接

蓝牙连接

- 打开蓝牙拨档开关。
- 小箱头电源指示灯由红色灯变为蓝色灯。
- 打开您设备的蓝牙功能。等待设备搜索到banTamp xL设备, 请注意, 搜索到的设备名称根据您购买的型号不同, 设备名也会不同, 实际的设备名称为banTamp xL的INPUT输入插口上方的英文名称, 例如: “JACKMAN II”。
- 点击对应的设备名称进行连接匹配。

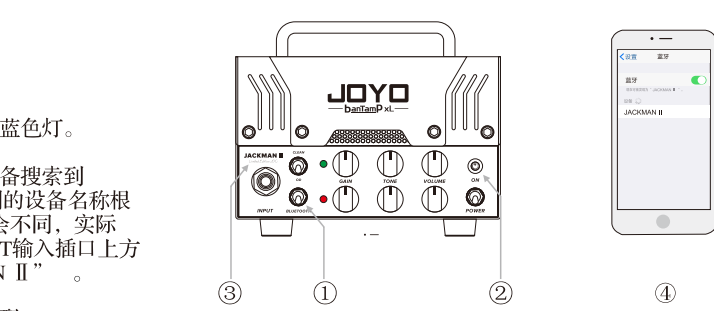

箱体阻抗匹配

与banTamp xL相匹配的最佳喇叭阻抗为8Ω, 当然, 也可以接入16Ω的喇叭, 但只有喇叭为8Ω时, banTamp xL能输出其最大功率, 当接入16喇叭时, banTamp xL的功率将会减小。

请不要接入阻抗小于8Ω的喇叭!

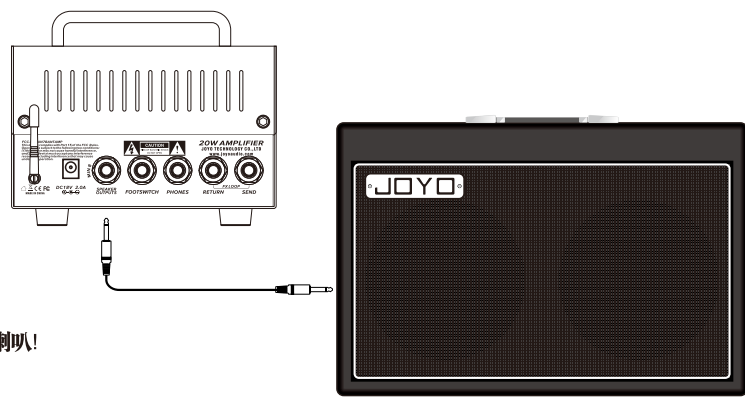

-4-

电气参数:

电源适配器规格: INPUT AC 100-240V 50/60Hz OUTPUT DC18V/2.0A
额定功率: 20W/8Ω
喇叭阻抗: 8Ω
耳机阻抗: 标准32Ω; 最小16Ω

蓝牙版本: 4.0
尺寸: 163mm × 110mm × 140mm
净重: 1.3kg

包装清单:

- 主机x1
- 电源适配器x1
- 电源线x1
- 说明书x1
- 通道切换踏板连接线x1
- 通道切换踏板x1
- 喇叭线x1

卓乐产品服务政策		卓乐产品保修卡																						
<p>一、在正常使用产品过程中,如产品出现非人为损坏的性能故障,自购买之日起,消费者享有保修服务,保修期为12个月。</p> <p>二、有下列情况之一者,消费者不能享受保修权益。</p> <p>1、人为损坏; 2、超过保修期; 3、无保修卡及有效发票,但能证明产品在保修期内的除外; 4、保修卡与产品型号不符,或保修卡被涂改; 5、未按说明书要求使用、维护、保养而造成产品损坏; 6、未经卓乐公司授权,擅自拆卸、维修产品、或改装、拼装产品; 7、其他不可抗力造成的损坏。</p> <p>三、卓乐售后服务:</p> <p>消费者服务热线: 0755-29765390</p> <p>更多详情请访问: www.joyochina.cn</p>		<table><tr><th>产品信息</th><th>姓名</th><th>S/N号码</th></tr><tr><td rowspan="4">用户信息</td><td>姓名</td><td>购买日期</td></tr><tr><td>电话</td><td></td></tr><tr><td>地址</td><td></td></tr><tr><td>邮政编码</td><td></td></tr><tr><td rowspan="4">销售单位信息</td><td>名称(加盖公章)</td><td></td></tr><tr><td>地址</td><td></td></tr><tr><td>电话</td><td></td></tr><tr><td></td><td></td></tr></table>		产品信息	姓名	S/N号码	用户信息	姓名	购买日期	电话		地址		邮政编码		销售单位信息	名称(加盖公章)		地址		电话			
产品信息	姓名	S/N号码																						
用户信息	姓名	购买日期																						
	电话																							
	地址																							
	邮政编码																							
销售单位信息	名称(加盖公章)																							
	地址																							
	电话																							
<p>品牌:JOYO</p> <p>名称: 吉电吉放大师</p> <p>执行标准:QB/T 4326-2012</p> <p>制造商: 深圳市卓乐科技有限公司</p> <p>地址: 广东省深圳市宝安区新安三路陆氏工业大厦2楼</p> <p>售后服务热线: 0755-29765390</p>		<table><tr><th colspan="2">产品合格证</th></tr><tr><td>检验结论</td><td>合格</td></tr><tr><td>检验员号</td><td>QC 01</td></tr><tr><td>日期</td><td></td></tr></table>		产品合格证		检验结论	合格	检验员号	QC 01	日期														
产品合格证																								
检验结论	合格																							
检验员号	QC 01																							
日期																								

-5-

JACKMAN II 金色 中英文 尺寸160*125mm 12页 材质105g铜板纸 齐马钉(环保)